



For exploded diagram and part number information, refer to the Spare Parts Catalog available on our website at [www.rockshox.com](http://www.rockshox.com).

Contact your local distributor or visit the RockShox website at [www.rockshox.com](http://www.rockshox.com) for ordering information.

Information contained in this publication is subject to change at anytime without prior notice.

For the latest technical information, visit our website at [www.rockshox.com](http://www.rockshox.com).

Names used in this manual may be trademarks or registered trademarks of others.

## WHY DO YOU NEED TO REPLACE YOUR SUSPENSION FORK BUSHINGS?

Suspension fork bushings are considered 'wear and tear' parts and require regular maintenance, depending on frequency of riding, riding terrain, rider body weight, use of disc brakes, and the type of fork you ride. The more you ride, the more frequently your bushings need to be replaced.

## SYMPTOMS OF WORN BUSHINGS

- Headset may feel loose
- Fork may knock when ridden

## CHECK FOR LOOSE BUSHINGS

1. Hold the front brake lever tight and rock the bike back and forth. If the fork feels like it's knocking, or the headset feels loose, proceed to steps 2 and 3.
2. **Check the fork:** Wrap your fingers around the dust seal and upper tube area. Rock the bike back and forth once again. Listen and feel if there is any play between the upper tube and the dust seal. If so, the bushings are loose.
3. **Check the headset:** Wrap your fingers around the headset upper cup, or lower cup/race areas. Holding the brake, rock the bike back and forth and feel if the headset is loose. If so, tighten the headset and check again.

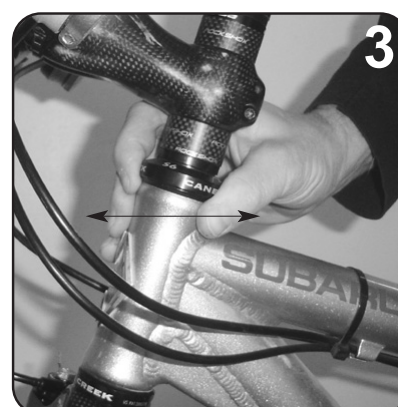
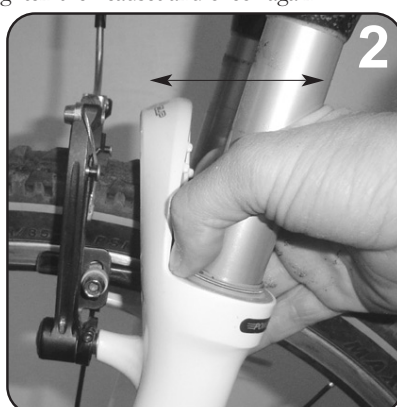
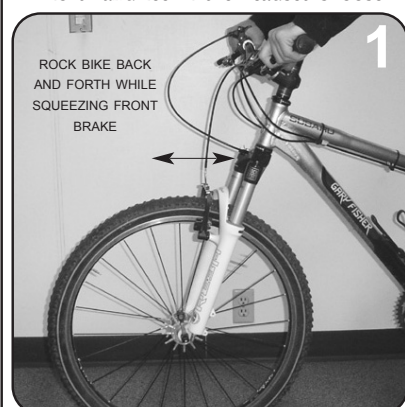

## PARTS NEEDED

Visit your local SRAM dealer for the tools and parts you will need. If the parts are not in stock, your dealer can place an order with their SRAM distributor. For a more comprehensive list of RockShox spare parts, check out the Spare Parts Catalog at [www.rockshox.com](http://www.rockshox.com) or [www.sram.com](http://www.sram.com).

| DUST SEAL KITS  |   |
|-----------------|---|
| 11.4307.250.000 | Pilot/SID Dust Seal/Foam Ring Kit                               |
| 11.4307.298.000 | Psylo/Duke Dust Seal/Foam Ring Kit                              |
| 11.4308.850.000 | Reba/Pike Dust Seal/Oil Seal/Foam Ring Kit                      |
| 11.4307.312.000 | Boxxer Dust/Oil Seal Replacement Kit                            |
| 11.4310.290.000 | Tora/Recon/Revel Dust Seal/Foam Ring Kit                        |
| BUSHING KITS    |   |
| 11.4307.251.000 | SID, Pilot, Judy Bushing Kit (10mm upr, 20mm lwr)               |
| 11.4307.280.000 | Duke Bushing Kit (30mm upr/30mm lwr)                            |
| 11.4307.296.000 | Psylo Bushing Kit (30mm upr/45mm lwr)                           |
| 11.4308.851.000 | Reba/Pike/Tora/Recon/Revelation Bushing Kit (30mm upr/30mm lwr) |
| 11.4305.621.000 | 00-04 Boxxer Bushing Kit (10mm upr/30mm lwr)                    |
| 11.4310.006.000 | 05-06 Boxxer Bushing Kit (10mm upr/76mm lwr)                    |

## TOOLS AND LUBRICANTS NEEDED

### STANDARD SHOP TOOLS

- Plastic Mallet
- Oil Pan
- Work bench with mounted vice
- 24mm Socket Wrench
- 22mm Socket Wrench (00-02 Boxxer)
- 10mm Socket Wrench (All Dual Air forks)
- 5mm hex wrench
- Flat-head screw driver
- Clean rags
- Oil mixing syringe (MixMizer)

### LUBRICANTS

- Isopropyl Alcohol/Spray Bottle
- Oil Soluable Grease
- 5, 10, or 15wt Suspension Oil
- Air shock pump (for re-assembly of air forks)



### ROCKSHOX BUSHING TOOLKITS

| Part Number     | Description  | Use with:                            |
|-----------------|--|--------------------------------------|
| 11.4306.351.000 | Fork Bushing Removal Tool (28mm/30mm/32mm)                                       | All Forks                            |
| 11.4307.499.000 | Psylo/Duke Bushing Removal Plate (30mm)  | 11.4306.351.000                      |
| 11.4306.352.000 | Fork Bushing Install Tool (28mm/30mm Upr Tube)                                   | Appropriate installation sleeve kit  |
| 11.4306.353.000 | Fork Bushing Install Tool (32mm Upr Tube)  | Appropriate installation sleeve kit  |
| 11.4307.498.000 | Judy/Pilot/SID Bushing Install Sleeve  | 11.4306.352.000                      |
| 11.4306.354.000 | Psylo/Duke Bushing Install Sleeve  | 11.4306.352.000                      |
| 11.4309.121.000 | Reba/Pike Bushing Install Sleeve   | 11.4306.353.000                      |
| 11.4310.701.000 | Tora/Recon/Revel Bushing Install Sleeve  | 11.4306.353.000                      |
| 11.4306.357.000 | 00-06 Boxxer Bushing Install Sleeve (sleeve only)                                | 11.4306.353.000                      |
| 11.4310.014.000 | 05-06 Boxxer Lwr Bushing Install Spacer (used with 00-05 Bushing Install Sleeve) | 11.4306.353.000 & 11.4306.357.000    |
| 11.4310.015.000 | 00-06 Boxxer Bushing Install Sleeve/Spacer (includes Sleeve and 05 Spacer)       | 11.4306.353.000                      |
| 11.4310.444.000 | Dust Seal Install Tool (28mm/30mm)   | 11.4306.352.000                      |
| 11.4308.722.000 | Dust/Oil Seal Install Tool (32mm)  | 32mm dust seals, no other tool req'd |

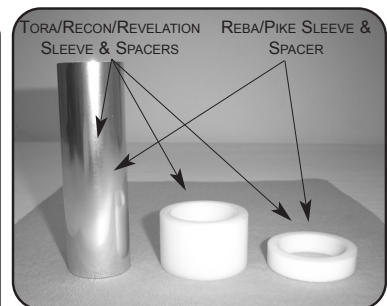

## REMOVAL: DUST SEALS, OIL SEALS & BUSHINGS

### DUST SEAL, FOAM RING, OIL SEAL REMOVAL

**SEE THE APPROPRIATE COMPLETE SERVICE GUIDES FOR FORK DISASSEMBLY AND ASSEMBLY PROCEDURES.**

**(ALL FORK MODELS: PILOT, SID, DUKE, PSYLO, BOXXER, REBA, PIKE, TORA, RECON AND REVELATION)**

1. Using a medium to large flat-head screwdriver, pry the old dust seal from the lower leg.
2. Remove the oil foam ring. Tora/Recon/Revelation and 06 Boxxer include foam rings under the dust seals.
3. Boxxer, Reba, Pike, 2000 and 2001 Judy, 2000-2001 SID and Psylo forks feature an inner oil seal, located just below the dust seal. To remove this oil seal, use a flat-head screwdriver to pry the seal from the lower leg. To protect the lower leg paint, place a rag in between the lower leg and the screwdriver. The improved current Samurai dust seal eliminates the need to replace the oil seal.
  - **2000 - 2002 BOXXER:** Remove snap ring and large washer above oil seal.



DUST SEAL REMOVAL - ALL FORKS



DUST SEAL REMOVAL - ALL FORKS

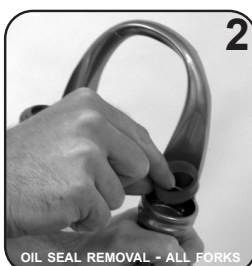

OIL SEAL REMOVAL - ALL FORKS



OIL SEAL REMOVAL - BOXXER



OIL SEAL REMOVAL - REBA/PIKE

### BUSHING REMOVAL - ALL MODELS

1. Clamp Bushing Removal Handle/Puller tool into bench vice. Clamp vice tight.
2. Install the correct bushing removal plate onto handle end and secure with handle plate screw.
  - 28mm Plate (Judy/Pilot/SID)
  - 30mm Plate (Duke/Psylo)
  - 32mm Plate (Boxxer/Reba/Pike/Tora/Recon/Revelation)
3. Slide the removal plate past the upper bushing, pull lower leg away from puller, and hook the flat end of the plate secure under the bushing. The removal plate pivots when inserted. When plate is secure under bushing, begin to remove.

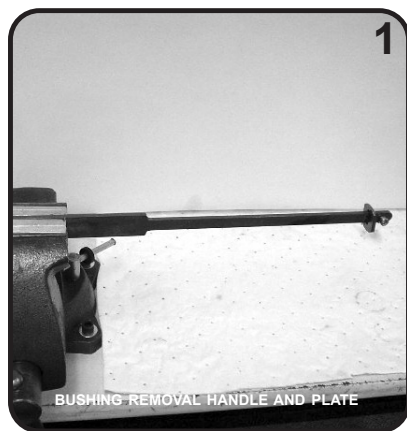

BUSHING REMOVAL HANDLE AND PLATE

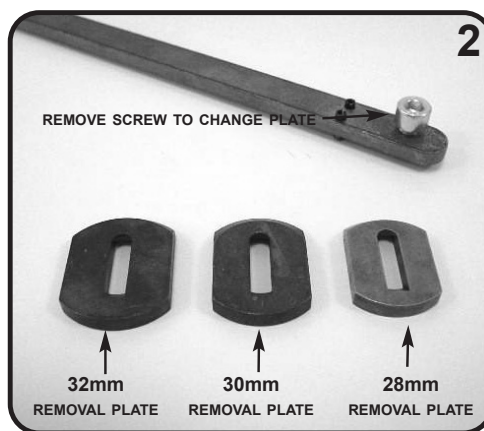

32mm REMOVAL PLATE 30mm REMOVAL PLATE 28mm REMOVAL PLATE





3. To pull the upper bushing free from the lower leg use a plastic mallet to firmly and squarely hit the top of the lower leg on the flat dust seal surface area until upper bushing pulls free.

**BOXXER** - Follow same procedure for Boxxer lower leg upper bushing and lower bushing removal.

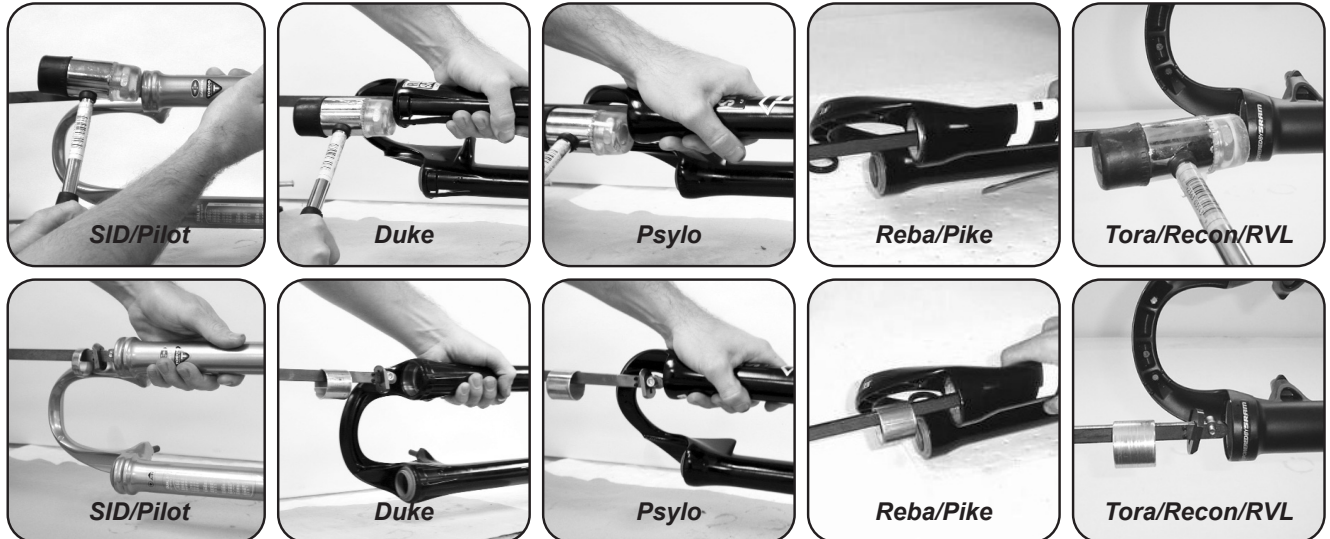

4. To pull the lower bushing free from the lower leg, slide the removal plate past the lower bushing, and hook the flat end of the plate secure under the bushing. Again, firmly hit the top of the lower leg (flat dust seal surface) until bushing pulls free. Longer lower bushings require more force.
5. Repeat other side. Wipe off any debris from lower leg inner surface.

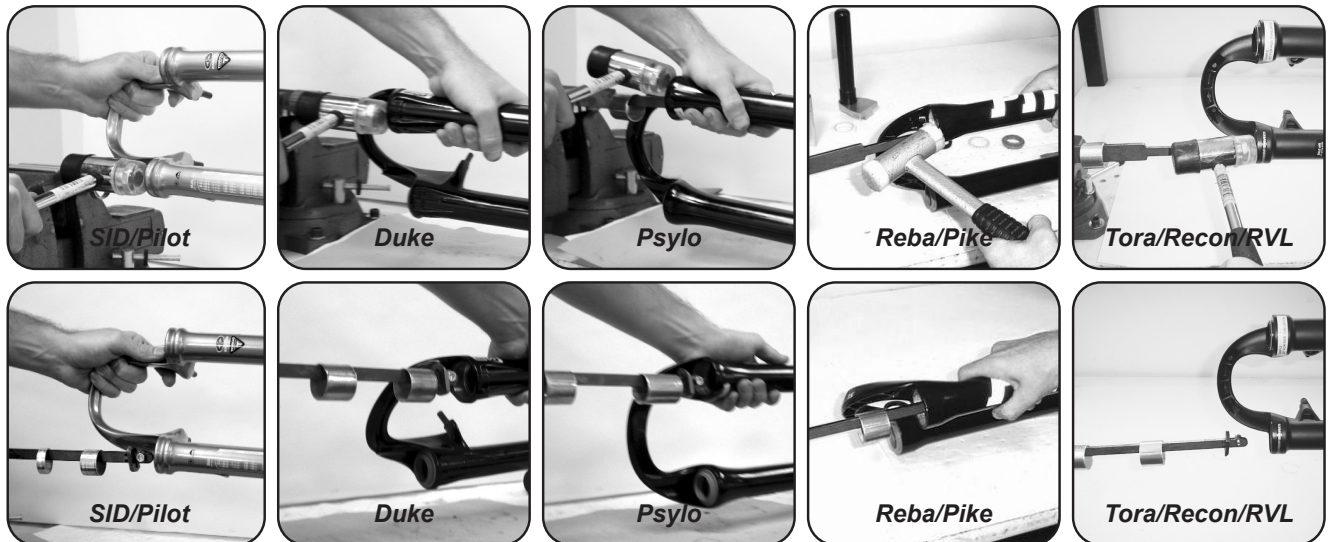

## BUSHING INSTALLATION

**BUSHING INSTALLATION: (00-02 JUDY/03-05 PILOT/99-06 SID) - 28MM WIDTH**

**LOWER BUSHING INSTALLATION: 28MM X 20MM**

1. Clamp 28mm/30mm bushing installation tool into bench-mounted vice.
2. Slide lower 28mm Pilot/SID bushing sleeve onto bushing installation post.
3. Slide 20mm lower bushing onto top of lower bushing installation sleeve.
4. Slide lower leg over installation post and rest on top of lower bushing.
5. Insert the mallet drift tool into the lower leg shaft hole, and hold in place with one hand.

6. Using a plastic mallet, hit the drift to press the bushing into the lower leg. Hit the drift until the lower leg dust seal ridge is level with the top of the installation post spacer. Stop and remove lower leg from tool.
7. Inspect the fit of the lower bushing by sliding one upper tube into the lower leg. Hold lower leg 90 degrees horizontally and release. Lower leg should swing 45 degrees down and stop. If the lower leg swings as described move on to upper bushing or install lower bushing on the other side. If the lower leg swings too freely, repeat step 6.
8. If lower leg does not swing at all or feels tight, slide lower leg back onto bushing installation bushing post and rock side to side to loosen fit.

**NOTE: SID LOWER LEG PICTURED. SAME PROCEDURE FOR 03-05 PILOT AND 00-02 JUDY.**

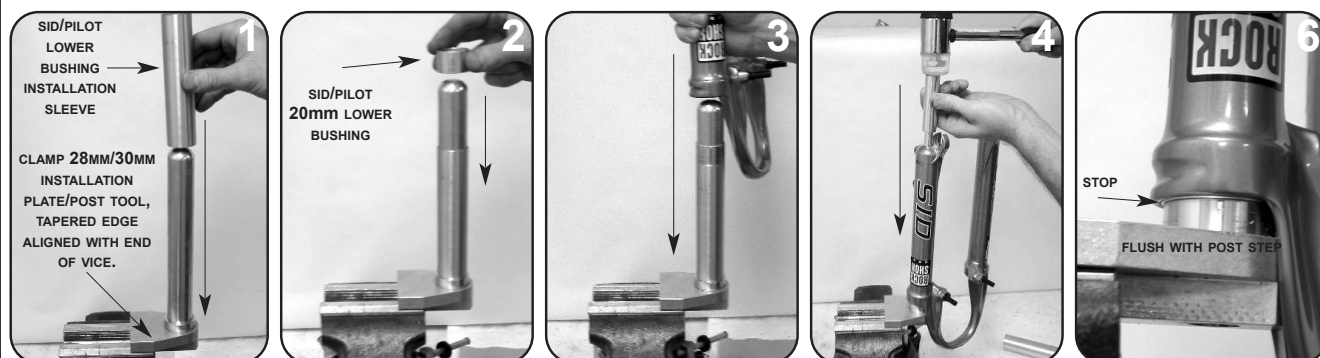

### UPPER BUSHING INSTALLATION: 28MM X 10MM

1. Remove lower bushing installation sleeve from bushing installation post.
2. Slide 10mm (first) and 5mm Judy/Pilot/SID upper bushing installation spacers onto bushing installation post, as pictured.
3. Slide 10mm upper bushing onto bushing installation post. Bushing will rest on top of 5mm spacer.
4. Slide lower leg over installation post and rest on top of upper bushing. Insert mallet drift tool into the lower leg shaft hole and hold in place. Using a plastic mallet, hit the mallet drift to press the bushing into the lower leg.
5. Hit the drift until the lower leg dust seal ridge is flush with the 5mm installation spacer. You will feel the stop point as the bushing is 'set' into lower leg.
6. Remove lower leg from tool and inspect upper bushing. The upper bushing should be flush with the top of the dust seal counter bore step. Do not press bushing below bore step. It is best to tap the bushing in then remove lower leg and check the fit. Tap lower leg until dust seal surface is even with lower step of post step.
7. Repeat other side.

**NOTE: SID LOWER LEG PICTURED. SAME PROCEDURE FOR PILOT AND 00-02 JUDY.**

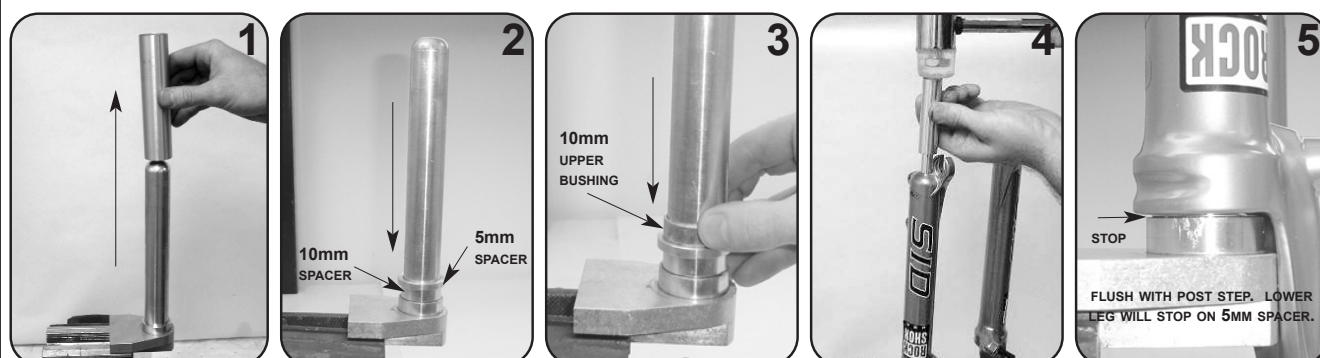

**BUSHING INSTALLATION: DUKE - 30MM WIDTH****LOWER BUSHING INSTALLATION: 30MM X 30MM SLOTTED**

1. Slide lower 15mm Duke lower bushing sleeve spacer (for 30mm lower bushing) onto installation post. Slide the long Duke/Psylo lower bushing sleeve onto bushing installation post. The sleeve will rest on top of 15mm spacer.
2. Slide 30mm slotted bushing (thin-walled) onto top of lower bushing installation sleeve.
3. Slide Duke lower leg over installation post, and rest on top of lower bushing.
4. Insert the mallet drift tool into the lower leg shaft hole and hold in place. Using the plastic mallet, hit the mallet drift tool to press the bushing into lower leg.
5. Hit the drift until the lower leg dust seal ridge is level with the top of the installation post spacer. You will feel the stop-point as the bushing is 'set' into the lower leg.
6. Repeat on other side.

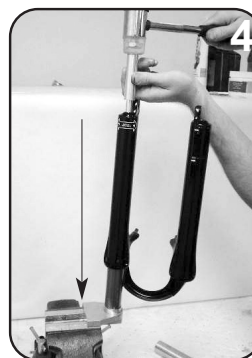
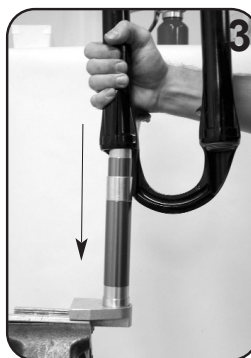
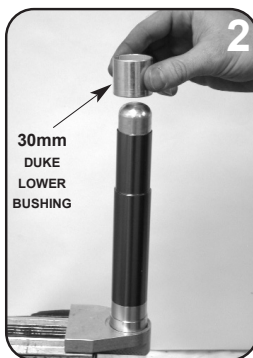
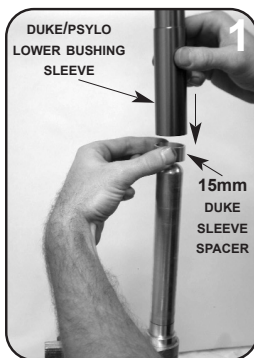
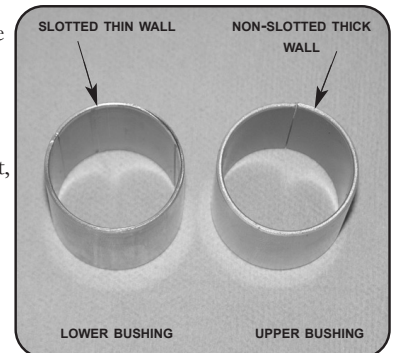
**UPPER BUSHING INSTALLATION: 30MM X 30MM**

1. Remove Duke lower bushing sleeve and spacer from bushing installation post.
2. Slide Duke/Psylo upper bushing installation sleeve onto bushing installation post. Bushing will rest on top of Duke/Psylo upper installation sleeve.
3. Slide 30mm Duke (thick-walled) upper bushing onto bushing installation post. Bushing will rest on top of Duke/Psylo upper bushing installation sleeve.
4. Slide Duke lower leg over installation post and rest on top of upper bushing.
5. Insert the mallet drift tool into the lower leg shaft hole and hold in place. Using the plastic mallet, hit the mallet drift tool to press the bushing into lower leg.
6. Hit the drift until the lower leg dust seal ridge is level with the top of the installation post spacer. You will feel the stop-point, as the bushing is 'set' into the lower leg.
7. Remove lower leg, and check bushing. Upper bushing should be flush with top of dust seal counter-bore step.
8. Repeat on other side.

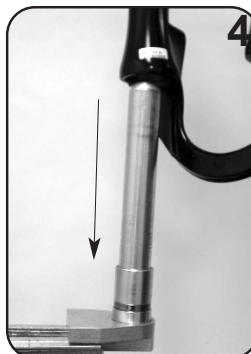
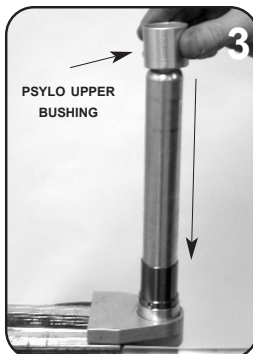
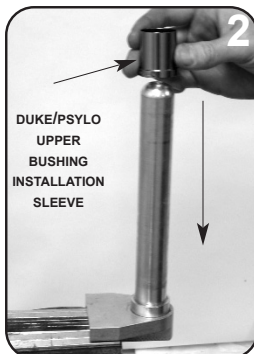



## BUSHING INSTALLATION: PSYLO - 30MM WIDTH

### LOWER BUSHING INSTALLATION: 30MM X 45MM SLOTTED

**IMPORTANT: 45MM LOWER BUSHING IS NOT COMPATIBLE WITH 2001 PSYLO LOWER LEGS. FOR 2001 PSYLO LOWER LEGS, REPLACE LOWER LEG ASSEMBLY WITH 2004 LOWER LEG ASSEMBLY IF BUSHINGS NEED TO BE REPLACED.**

1. Slide the Duke/Psylo lower bushing sleeve onto bushing installation post.
2. Slide 45mm slotted bushing (thin-walled) onto top of lower bushing installation sleeve.
3. Slide Psylo lower leg over installation post, and rest on top of lower bushing.
4. Insert the mallet drift tool into the lower leg shaft hole, and hold in place. Using the plastic mallet hit the mallet drift tool to press the bushing into lower leg.
5. Hit the drift until the lower leg dust seal ridge is level with the top of the installation post spacer. You will feel the stop-point, as the bushing is 'set' into the lower leg.
6. Repeat on other side.

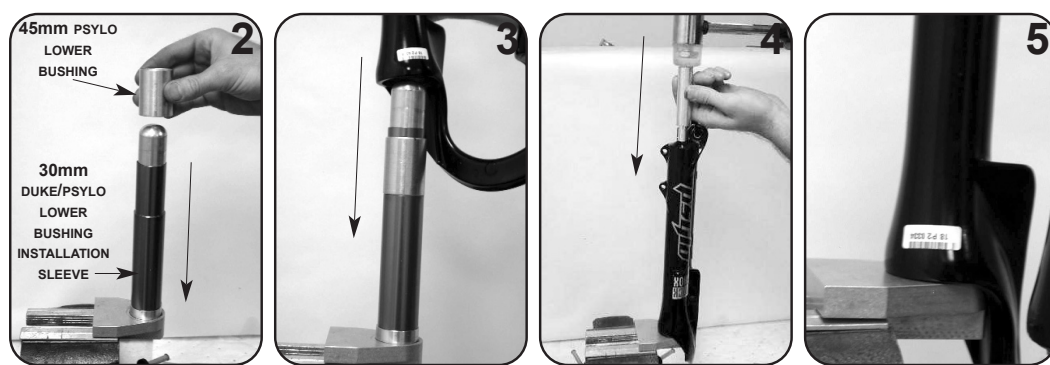

### UPPER BUSHING INSTALLATION: 30MM X 30MM (COMPATIBLE WITH ALL PSYLO LOWER LEGS)

1. Remove Duke/Psylo lower bushing sleeve from bushing installation post.
2. Slide Duke/Psylo upper bushing installation sleeve onto bushing installation post, thin side up.
3. Slide 30mm Psylo upper bushing (thick-wall bushing) onto bushing installation post. Bushing will rest on top of bushing installation sleeve.
4. Slide lower leg over installation post, and rest on top of upper bushing.
5. Insert mallet drift tool into Psylo lower leg shaft hole, and hold in place. Using a plastic mallet, hit the mallet drift tool to press the bushing into the lower leg.
6. Hit the drift until the lower leg dust seal ridge is flush with the installation post plate. You will feel the stop-point as the bushing is 'set' into lower leg.
7. Remove lower leg from post tool and check upper bushing. Bushing should be flush with the top of the dust seal counter-bore step.
8. Repeat other side.

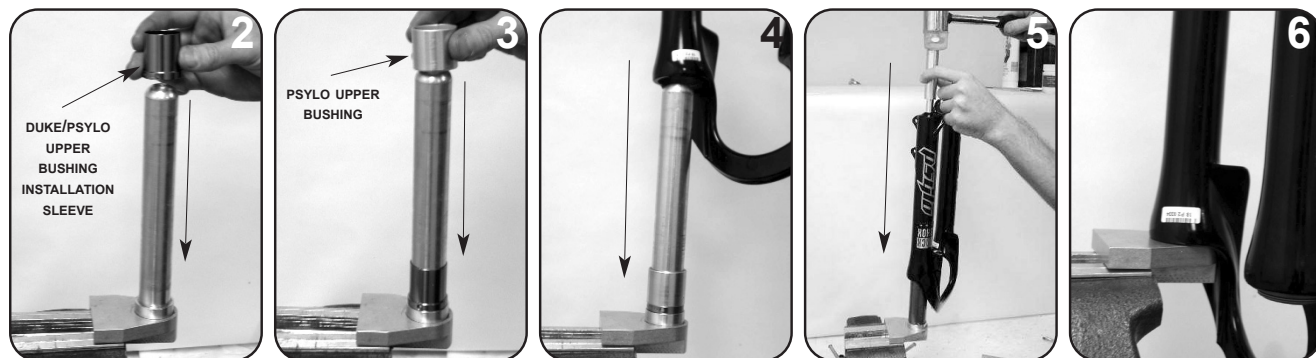



## BUSHING INSTALLATION: REBA/PIKE - 32MM WIDTH

### LOWER BUSHING INSTALLATION: 32MM X 30MM - SLOTTED

(PIKE PICTURED, SAME PROCEDURE FOR PIKE AND REBA)

1. Slide the Reba/Pike lower bushing sleeve spacer onto 32mm bushing installation post.
2. Slide Reba/Pike lower bushing installation sleeve on 32mm bushing installation post.
3. Slide Reba/Pike 30mm thick slotted lower bushing onto the top of the lower installation sleeve.
4. Slide lower leg over installation post and rest on top of lower bushing.
5. **Reba:** Insert mallet drift tool into the lower leg shaft hole and hold in place. (not pictured)
6. Using a plastic mallet, hit the bottom of the lower leg (Pike), or the mallet drift tool (Reba) to press the bushing into the lower leg.
7. Hit the lower leg, or mallet drift, until the lower leg dust seal ridge is level with the top of the installation post spacer. You will feel the stop-point as the bushing is 'set' into the lower leg.
8. Repeat on other side.

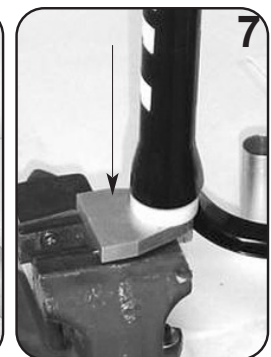
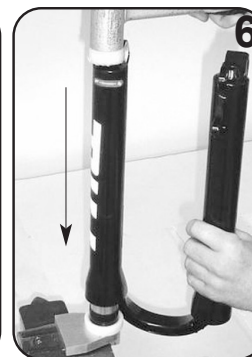
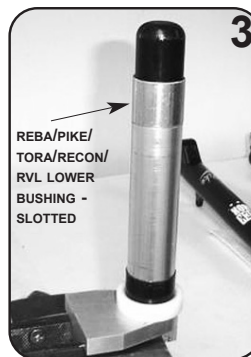
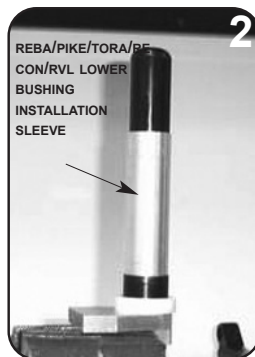
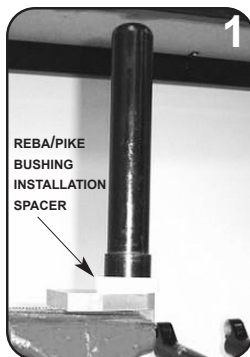

### UPPER BUSHING INSTALLATION: 32MM X 30MM - NON SLOTTED

(PIKE PICTURED, SAME PROCEDURE FOR PIKE AND REBA)

1. Remove Reba/Pike lower bushing sleeve. Leave lower bushing spacer on installation post/base tool.
2. Slide 30mm Reba/Pike upper bushing (non-slotted) onto 32mm bushing installation post.
3. Slide lower leg over installation post, and rest on top of the upper bushing.
4. **Reba:** Insert mallet drift tool into the lower leg shaft hole and hold in place. (not pictured)
5. Using the plastic mallet, hit the mallet drift tool (Reba), or bottom of lower leg (Pike), to press the upper bushing into lower leg.
6. Hit the drift until the lower leg rests flush on top of install spacer. You will feel the stop-point as the bushing is 'set' into the lower leg. Remove the lower leg from the installation post, and check the bushing fit. The top of the bushing should be flush/level with oil seal step in the lower leg.
7. Repeat on other side.

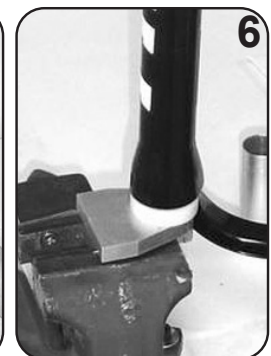
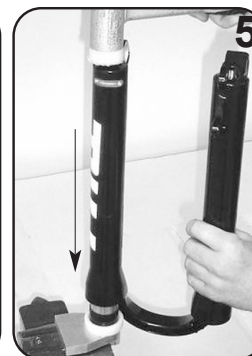
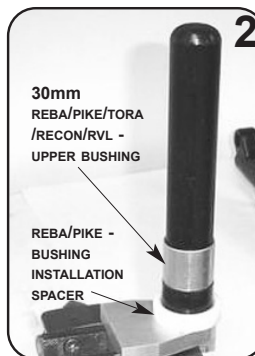

**BUSHING INSTALLATION: TORA/RECON/REVELATION - 32MM WIDTH****LOWER BUSHING INSTALLATION: 32MM X 30MM - SLOTTED****(ALL USE THE SAME LOWER LEG ASSEMBLY. PROCEDURE IS THE SAME FOR ALL THREE)**

1. Slide the Reba/Pike/Tora/Recon/Revelation lower bushing sleeve spacer onto 32mm bushing installation post.
2. Slide the Reba/Pike/Tora/Recon/Revelation short lower bushing installation spacer on 32mm bushing installation post).
3. Slide the Tora/Recon/Revelation tall lower bushing spacer onto the 32mm bushing installation post.
4. Slide Reba/Pike/Tora/Recon/Revelation 30mm thick slotted lower bushing onto the top of the lower installation sleeve.
5. Slide lower leg over installation post and rest on top of lower bushing.
6. Insert mallet drift tool into the lower leg shaft hole and hold in place. Using a plastic mallet, hit the bottom of the lower leg mallet drift tool to press the bushing into the lower leg.
7. Hit the lower leg, or mallet drift, until the lower leg dust seal ridge is level with the top of the installation post spacer. You will feel the stop-point as the bushing is 'set' into the lower leg.
8. Repeat on other side.

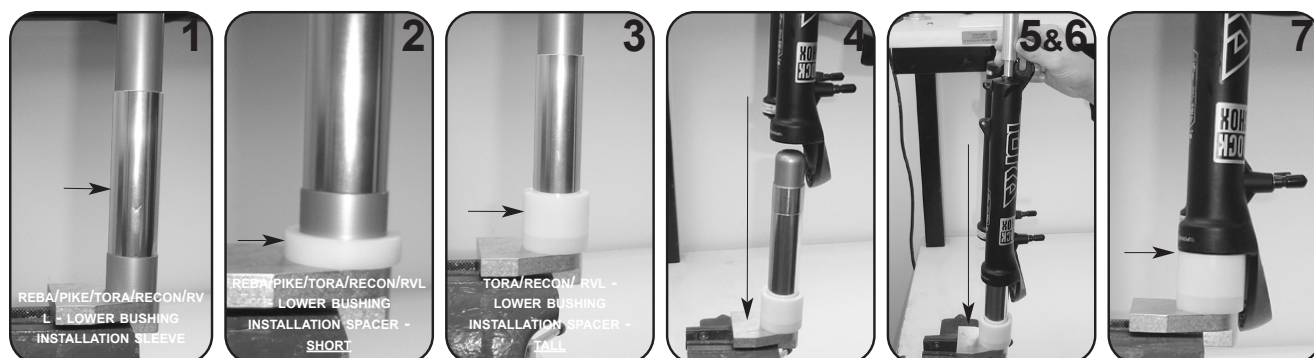
**UPPER BUSHING INSTALLATION: 32MM X 30MM - NON SLOTTED****(ALL USE SAME LOWER LEG ASSEMBLY. PROCEDURE IS THE SAME FOR ALL THREE)**

1. Remove Reba/Pike/Tora/Recon/Revelation lower bushing sleeve and tall Tora/Recon/RVL installation spacer. Leave lower bushing spacer on installation post/base tool.
2. Slide 30mm Reba/Pike/Tora/Recon/Revelation upper bushing (non-slotted) onto 32mm bushing installation post.
3. Slide lower leg over installation post, and rest on top of the upper bushing.
4. Insert mallet drift tool into the lower leg shaft hole and hold in place. Using the plastic mallet, hit the mallet drift tool to press the upper bushing into lower leg.
6. Hit the drift until the lower leg rests flush on top of install spacer. You will feel the stop-point, as the bushing is 'set' into the lower leg. Remove the lower leg from the installation post, and check the bushing fit. The top of the bushing should be flush/level with oil seal step in the lower leg.
7. Repeat on other side.

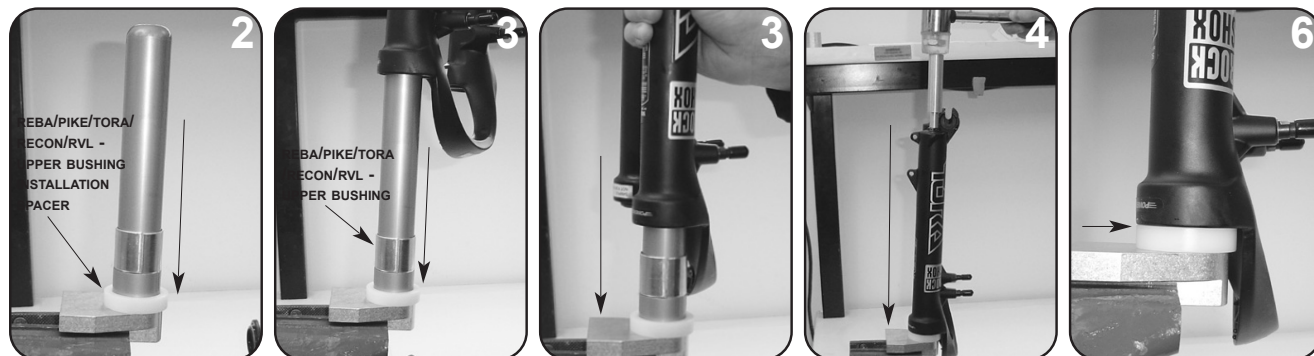

**BUSHING INSTALLATION: BOXXER - 32MM WIDTH****LOWER BUSHING INSTALLATION: 32MM X 30MM (2000-2004)**

**NOTE:** 05-06 76MM LOWER BUSHINGS ARE NOT COMPATIBLE WITH 2000-2004 BOXXER LOWER LEGS.

**PREPARATION:** CLAMP THE 32MM BUSHING INSTALLATION POST TOOL INTO VICE.

1. Slide the Boxxer lower bushing installation sleeve onto bushing installation post.
2. Slide 30mm lower bushing onto top of lower bushing installation sleeve.
3. Slide Boxxer lower leg over installation post, and rest on top of lower bushing.
4. Insert the mallet drift tool into the lower leg shaft hole, and hold in place..
5. Using the plastic mallet, hit the mallet drift tool to press the bushing into lower leg.
6. Hit the drift until the lower leg dust seal ridge is level with the top of the installation post spacer. You will feel the stop-point, as the bushing is 'set' into the lower leg.
7. Repeat on other side.

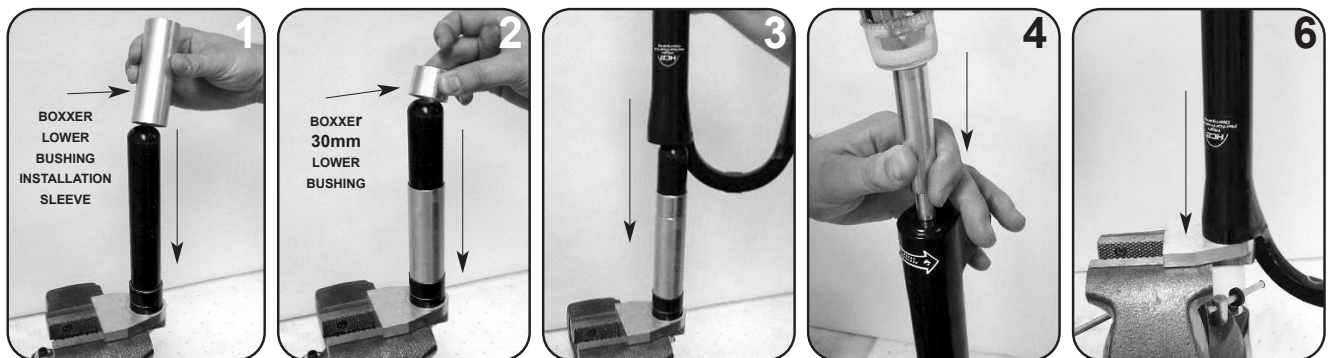
**LOWER BUSHING INSTALLATION: 32MM X 76MM (2005-2006)**

**IMPORTANT:** THE 76MM BOXXER LOWER BUSHING IS NOT COMPATIBLE WITH THE 2000-2004 BOXXER LOWER LEG.

**PREPARATION:** CLAMP THE 32MM BUSHING INSTALLATION POST TOOL INTO VICE.

1. Slide the Boxxer lower bushing sleeve and 76mm Boxxer lower bushing installation spacer over post tool, and rest on bottom of plate.
2. Slide 76mm lower bushing on top of lower bushing installation sleeve.
3. Slide Boxxer lower leg over installation post, and rest on top of lower bushing.
4. Insert the mallet drift tool into the lower leg shaft hole, and hold in place. Using the plastic mallet, hit the mallet drift tool to press the bushing into lower leg.
5. Hit the drift until the lower leg dust seal ridge is flush with the top of the installation post spacer. You will feel the stop-point, as the bushing is 'set' into the lower leg.
6. Repeat on other side.

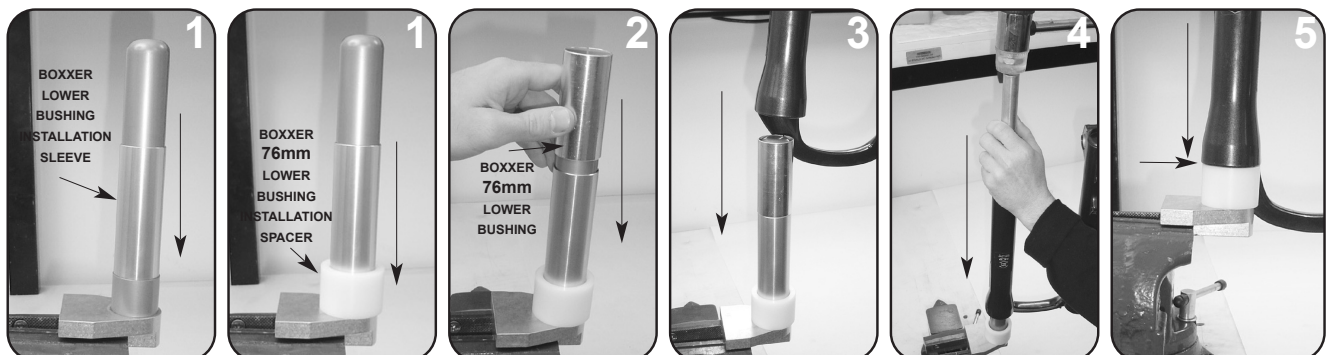

# UPPER BUSHING INSTALLATION: 32MM X 10MM

1. Remove Boxxer lower bushing sleeve and 05/06 lower bushing spacer (if used on 05/06 Boxxer lower leg) from Boxxer bushing installation post.
2. Slide 10mm Boxxer upper bushing onto Boxxer bushing installation post.
3. Slide lower leg over installation post and rest on top of upper bushing.
4. Insert Boxxer mallet drift tool into the lower leg shaft hole and hold in place. Using the plastic mallet, hit the mallet drift tool to press the upper bushing into lower leg.
5. Hit the drift until the lower leg dust seal ridge is flush with the upper bushing/oil seal step in the lower leg. The 'stop-point' on the post tool is about 5mm above the plate. You will feel the stop-point, as the bushing is 'set' into the lower leg. Remove the lower leg from this installation post, and check the bushing fit. The top of the bushing should be flush/level with oil seal step in the lower leg.
6. Repeat on other side.

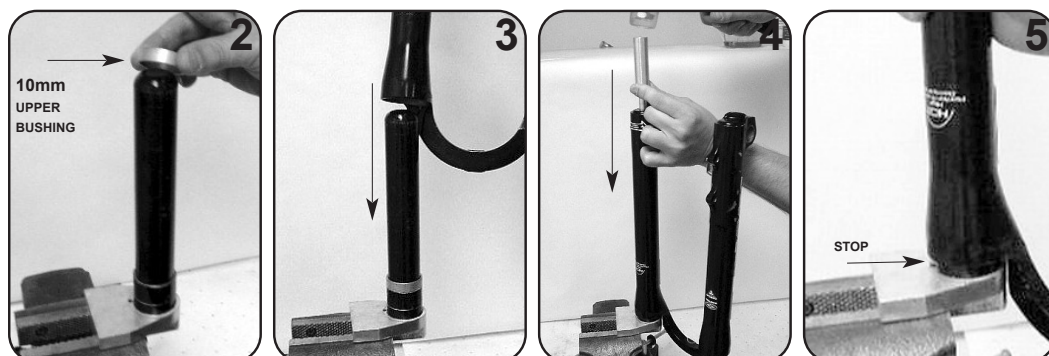

# INSTALLATION: DUST SEALS & FOAM RINGS

## JUDY/PILOT/SID/DUKE/PSYLO - 28MM/30MM WIDTH

(SID LOWER LEG PICTURED. SAME PROCEDURE FOR PILOT, DUKE AND PSYLO.)

1. Soak new foam rings in 5, 10 or 15wt suspension oil.
2. Slide 28mm/30mm Dust Seal Installation Tool over 28mm/30mm Bushing Installation Post tool.
3. Slide new dust seal over bushing installation post tool and fit on top of Dust Seal Installation tool.
4. Slide oil-saturated foam ring over bushing installation post tool and fit on top of dust seal. Seat the foam ring inside the under cavity of dust seal.
5. Using a clean rag and isopropyl alcohol, clean the inside of the dust seal area of the lower leg.
6. Slide lower leg onto bushing installation post, on top of new dust seal. Using a plastic mallet, lightly tap on the lower leg drop-out until dust seal seats inside lower leg, flush with the top of lower leg dust seal step.
7. Dust seal should be press-fit snug into the lower leg.
8. Repeat on other side.

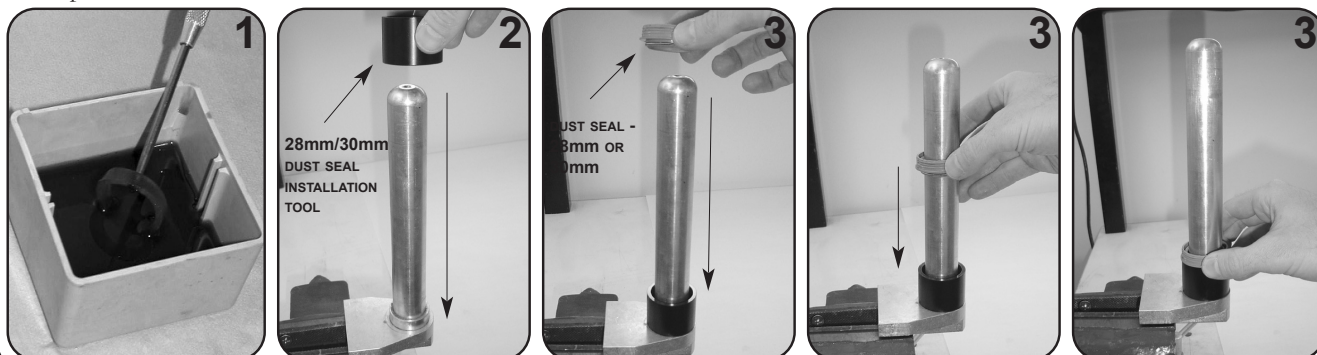



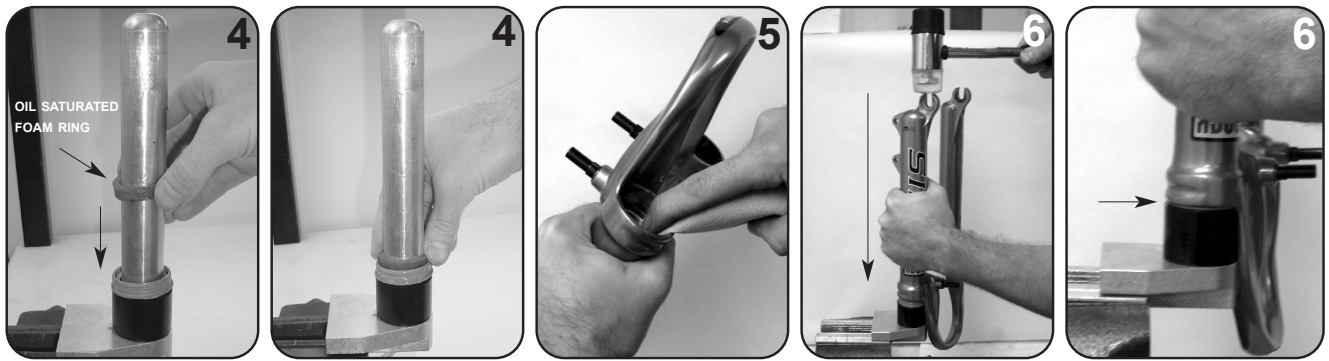

### REBA/PIKE/BOXXER (INCLUDES OIL SEAL)

#### OIL SEAL INSTALLATION (BOXXER PICTURED SAME PROCEDURE FOR REBA AND PIKE)

1. Apply grease or 15wt suspension oil to the inside of the Reba, Pike or Boxxer lower leg oil seal counter-bore.
2. Insert the oil seal onto the stepped end of the 32mm Oil Seal Installation tool.
3. Using the 32mm Oil Seal Installation tool, insert the oil seal down and into the oil step in the lower leg. Apply pressure on all sides of the oil seal to seat it into place.

**BOXXER NOTE:** THE 2000-2002 OIL SEAL WASHER AND SNAP RING ARE NO LONGER REQUIRED WHEN REPLACING OIL AND DUST SEALS. NO NEED TO RE-INSTALL. 2006 DUST SEAL KITS DO NOT INCLUDE THE OIL SEAL WASHER AND SNAP RING.

#### FOAM RING INSTALLATION

4. **REBA/PIKE/BOXXER:** Insert new oil-saturated foam ring into lower leg and on top of newly installed oil seal.
- BOXXER:** 2006 Dust Seal kits include foam rings and are compatible with all Boxxer lower legs assemblies.

#### DUST SEAL INSTALLATION

5. Insert new dust seal into the opposite (wide) end of the 32mm dust seal installation tool.
6. Insert dust seal into lower leg and press straight down evenly to seat into lower leg.
7. Dust seal should be press-fit snug and flush into lower leg.

**NOTE:** CHECK FOAM RING UNDER DUST SEAL. FOAM RING SHOULD NOT PROTRUDE FROM DUST SEAL AND OIL RING. IF SO, ADJUST FOAM RING INSIDE LOWER LEG, FLUSH ALL ON SIDES.

8. Repeat on other side.





### TORA/RECON/REVELATION (NO OIL SEAL)

#### FOAM RING INSTALLATION:

1. Insert new oil-saturated foam ring into lower leg.

#### DUST SEAL INSTALLATION:

2. Insert new dust seal into the wide open end of the 32mm dust seal installation tool.
3. Insert dust seal into lower leg and press straight down evenly to seat into lower leg.
4. Dust seal should be press-fit snug and flush into lower leg.

**NOTE:** CHECK FOAM RING UNDER DUST SEAL. FOAM RING SHOULD NOT PROTRUDE FROM DUST SEAL AND OIL RING. IF SO, ADJUST FOAM RING INSIDE LOWER LEG, FLUSH ALL ON SIDES.

5. Repeat on other side.

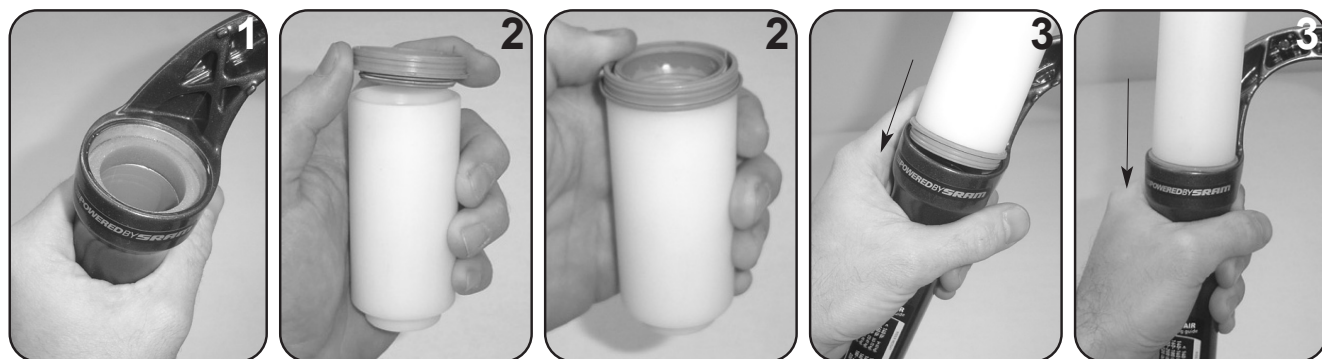

### FINISHING UP

1. Spray entire completed lower leg assembly with isopropyl alcohol.
2. Wipe lower leg assembly clean with a rag.
3. Check decals and replace if necessary.
4. Refer to the 'Lower Leg Removal and Installation Service Guide' or individual fork model service guides for installation procedures.

